

SYMBOL LEGEND	
	MAN DOOR LOCATIONS
	LOADING DOCK LOCATIONS
	DRIVE-IN LOCATIONS
	ENTRANCE & EXIT VESTIBULES
	DIRECTION OF TRAFFIC FLOW
	LANDSCAPE ISLANDS: 150 CONC. CURB CONT. AS SHOWN ON LANDSCAPE. SEE LANDSCAPE DWG.
	PAINTED ISLANDS: PAINTED TRAFFIC ISLAND COLOUR AS PER PAINT SPEC.
	CURB-CUTS FOR ACCESSIBLE ACCESS
	GAS METER LOCATION (REFER TO MECHANICAL & CIVIL DRAWINGS)
	SNOW STORAGE
	EASEMENT
	PROPERTY LINE
	DESIGNATED FIRE-ROUTE (REFER TO CIVIL DRAWINGS FOR PAVING)
	ACCESSIBLE PARKING SIGN

ACCESSIBLE PARKING STALL	
	FIRE HYDRANT AND VALVE (REFER TO TYPICAL SITE PLAN DETAILS)
	FIRE DEPT. CONNECTION
	ALTERNATIVE FUELING STATION
	GARBAGE ROOM
	ELECTRICAL ROOM
	MECHANICAL ROOM
	CART CORRAL
	BICYCLE RACK LAYOUT CONFORMS TO "GUIDELINES FOR DESIGN & MANAGEMENT OF BICYCLE PARKING FACILITIES"
	ROOF DRAIN
	FIRE ANNUNCIATOR PANEL
	FIRE ALARM
	CANADA POST FACILITY
	LIGHTING REFERENCE (REFER TO ELECTRICAL DRAWINGS)
	FIRE-ROUTE SIGN
	IMPRESSED ASPHALT

SITE ANALYSIS (SCHEME 8)		
LOT AREA:	36,750.98 S.M.	(9.08 ACRES)
BUILDING AREA:		
BLDG 'A' (FOOD STORE)	3,248.36 S.M.	(34,966.20 S.F.)
BLDG 'B' (RETAIL)	568.90 S.M.	(6,123.79 S.F.)
BLDG 'C' (RETAIL)	743.20 S.M.	(8,000.00 S.F.)
BLDG 'D' (RETAIL)	1,133.38 S.M.	(12,200.00 S.F.)
BLDG 'E' (RETAIL)	1,412.08 S.M.	(15,200.00 S.F.)
BLDG 'F' (RETAIL)	575.98 S.M.	(6,200.00 S.F.)
BLDG 'G' (RETAIL)	371.60 S.M.	(4,000.00 S.F.)
BLDG 'H' (RETAIL)	278.70 S.M.	(3,000.00 S.F.)
TOTAL GROSS FLOOR AREA:	8,332.20 S.M.	(89,698.99 S.F.)
COVERAGE:	22.67%	
PARKING REQUIRED:		
FOOD STORE:	3,248.36 S.M. @ 3.4 CARS / 100 S.M.	111 SPACES
RETAIL:	5,083.84 S.M. @ 5 CARS / 100 S.M.	254 SPACES
TOTAL PARKING REQUIRED:		365 SPACES
PARKING PROVIDED:		371 SPACES
PAVED AREA:	--	
LANDSCAPE AREA:	--	

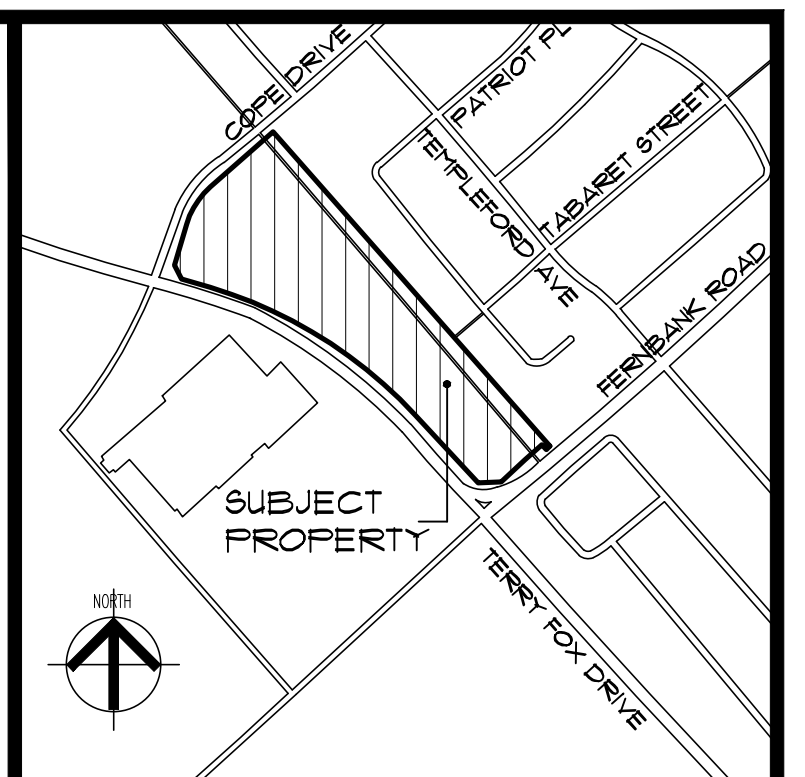

KEY MAP
N.T.S.

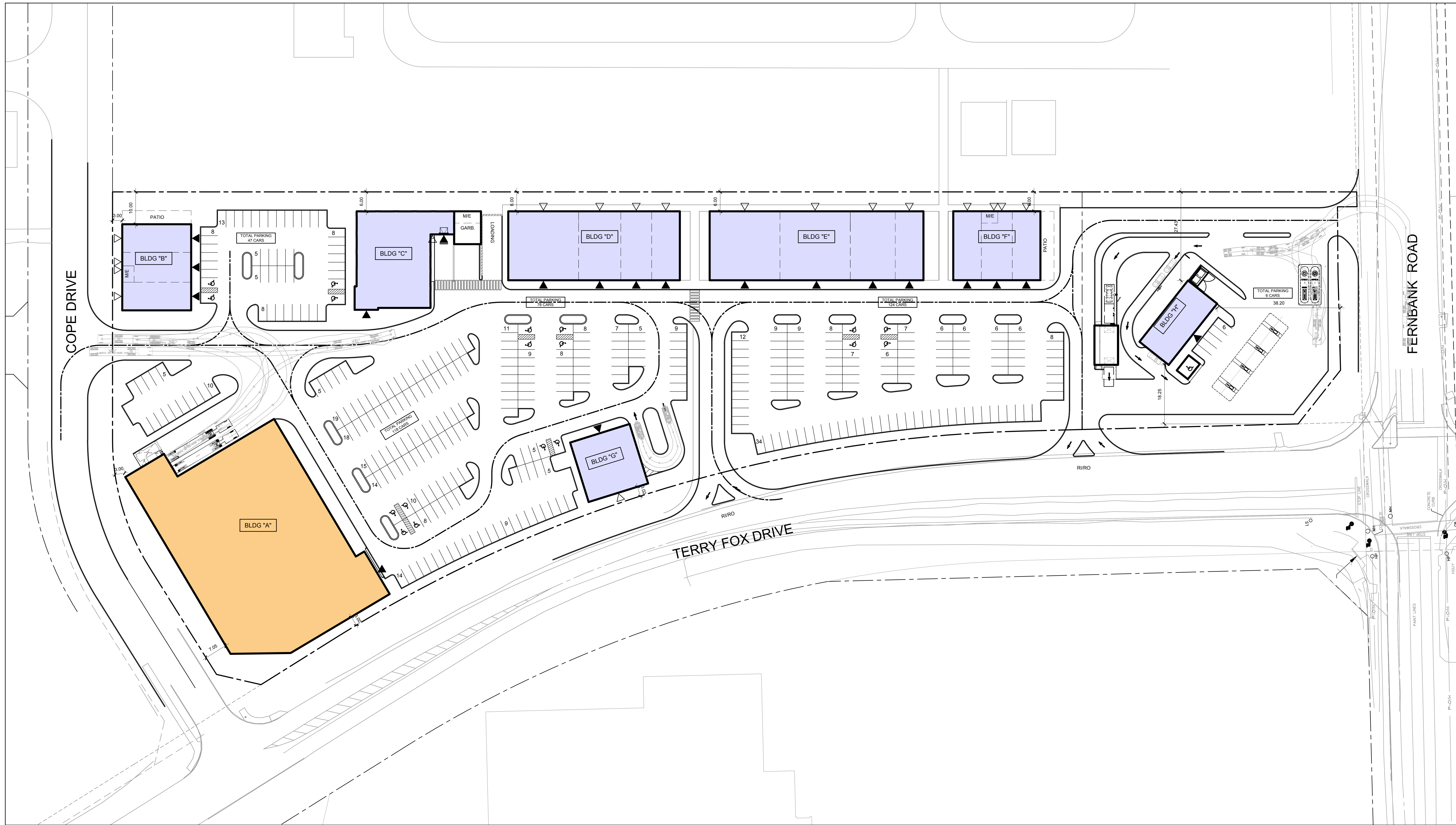

NO.	DATE	REVISIONS	BY

DRAWING ISSUE

DATE	PARTICULARS	BY
	Issued for Design Approval	
	Issued for Site Plan Approval	
	Issued for Pricing and Budgeting	
	Issued for Building Permit	
	Issued for Tendering	
	Issued for Construction	
	Issued for Record Set of Dwg.	

This drawing, as an instrument of service, is provided by and is the property of Venchiarutti Gagliardi Architect Inc. The contractor must verify and accept responsibility for all dimensions and conditions on site and must notify Venchiarutti Gagliardi Architect Inc. of any variations from the supplied information.

Venchiarutti Gagliardi Architect Inc. is not responsible for the accuracy of survey, structural, mechanical, electrical, etc. engineering information shown on this drawing. Refer to the appropriate engineering drawings before proceeding with the work.

Construction must conform to all applicable codes and requirements of authorities having jurisdiction. This drawing is not to be scaled.

Venchiarutti Gagliardi Architect Inc. is not responsible for any environmental conditions, geological conditions or any pollutants found on site.

All architectural symbols indicated are graphic representations only.

This drawing is not to be used for construction purposes until the architectural seal is signed by the Architect of Record.

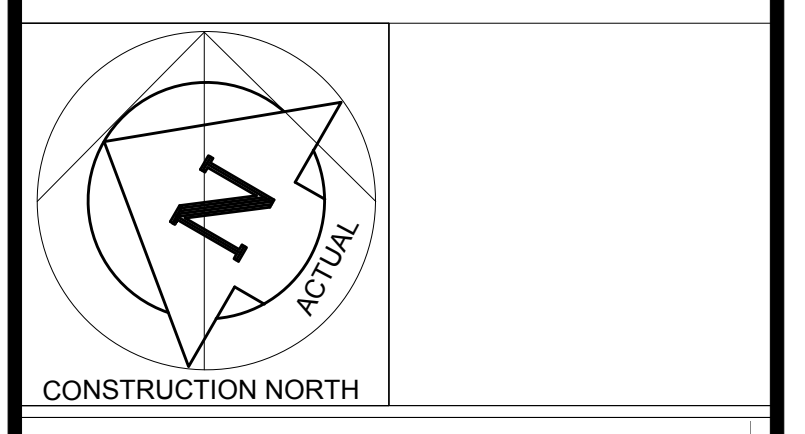

VGA Venchiarutti Gagliardi Architect Inc.
2651 John Street, Unit 18, Markham, ON L3R 2W5
T 905-477-1065 F 905-477-1067
www.vgarch.net

PROJECT
PROPOSED MIX-USE COMMERCIAL DEVELOPMENT
TERRY FOX DRIVE & COPE DRIVE
KANATA, ONTARIO

DRAWING NAME		
SITE PLAN		
CITY FILE #		
SCALE	DATE OF DWG	PROJECT NO.
1:300	MAY 31, 2018	17053
DRAWN BY	SHEET NO.	
DWL	A-100	
CHKD BY	SCHEME 8	
RDG		

1 SITE PLAN
SCALE: 1:300

LAST PLOTTING DATE: MAY 31, 2018